

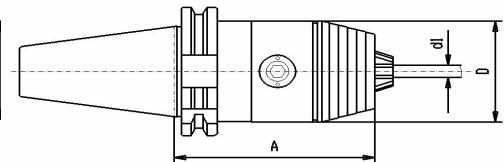

# Range of Drill-chucks DIN 69871

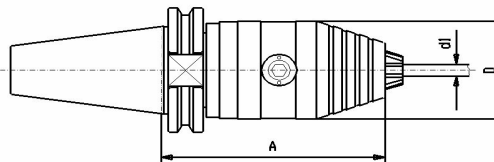
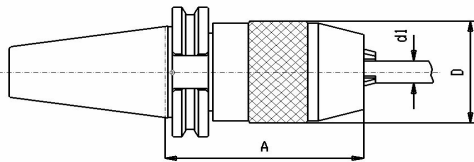

## Standard-Drill-chuck

for **right-hand-rotation**  
runout. **max 50µm** at 3 x d1  
with wrench  
manual pre-clamping possible

Article-code	Form A			
	SK x d1	A	D	€/ St.
<b>G332</b>	<b>40 x 13</b>	87	51	<b>135,50</b>
<b>G332</b>	<b>40 x 16</b>	110	57	<b>151,50</b>
<b>G332</b>	<b>50 x 13</b>	86	51	<b>166,00</b>
<b>G332</b>	<b>50 x 16</b>	90	57	<b>176,00</b>

## Precision-Drill-chuck **NEW**

for **left+right-hand-rotation**  
runout. **max 40µm** at 3 x d1  
with wrench

Article-code	Form A			
	SK x d1	A	D	€/ St.
<b>G333</b>	<b>40 x 13</b>	96	50	<b>169,00</b>
<b>G333</b>	<b>40 x 16</b>	101	50	<b>181,00</b>
<b>G333</b>	<b>50 x 13</b>	96	50	<b>212,00</b>
<b>G333</b>	<b>50 x 16</b>	101	50	<b>227,00</b>

## High-Precision-Drill-chuck

for **left+right-hand-rotation**  
runout. **max 30µm** at 3 x d1  
with wrench

Article-code	Form A			
	SK x d1	A	D	€/ St.
<b>G334</b>	<b>30 x 8</b>	70	36	<b>339,00</b>
<b>G334</b>	<b>30 x 13</b>	111	50	<b>302,50</b>
<b>G334</b>	<b>40 x 8</b>	76	36	<b>244,00</b>
<b>G334</b>	<b>40 x 13</b>	90	50	<b>207,50</b>
<b>G334</b>	<b>40 x 16</b>	95	57	<b>227,50</b>

<b>G334</b>	<b>50 x 13</b>	110	50	<b>248,50</b>
<b>G334</b>	<b>50 x 16</b>	115	57	<b>264,00</b>

Article-code	Form AD/B			
	SK x d1	A	D	€/ St.
<b>G334D</b>	<b>40 x 8</b>	76	36	<b>311,00</b>
<b>G334D</b>	<b>40 x 13</b>	95	50	<b>269,50</b>
<b>G334D</b>	<b>40 x 16</b>	100	57	<b>293,00</b>

<b>G334D</b>	<b>50 x 13</b>	110	50	<b>321,50</b>
<b>G334D</b>	<b>50 x 16</b>	115	57	<b>354,00</b>

**Form A** = no through coolant  
**Form AD/B** = combined inner coolant supply

Clamping range d1 = 8 clamps 0,5 mm to 8 mm  
Clamping range d1 = 13 clamps 1 mm to 13 mm  
Clamping range d1 = 16 clamps 3 mm to 16 mm

All 3 versions are also available in **DIN2080** and **MAS BT**  
The High-precision drill chuck is available in **HSK-A63 / A100**  
Please send an enquiry !

Order-example: G333 50x16

Further technical information on [WWW.KFH-Hermann.de](http://WWW.KFH-Hermann.de)



**Karl Hermann GmbH** Varnbülerstrasse 10-12 D-71229 Leonberg  
Tel.: ++49-7152-939920 E-Mail: Verkauf@KFH-Hermann.de